

**1.226**  
 PESO TEORICO: 0.367  
 PERIMETRO: 0.26

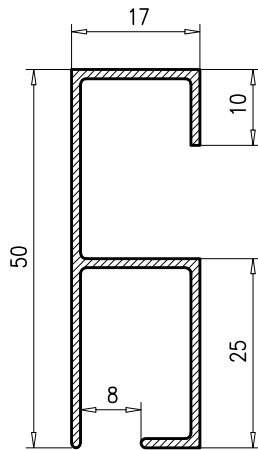

**1.486**  
 PESO TEORICO: 0.392  
 PERIMETRO: 0.24

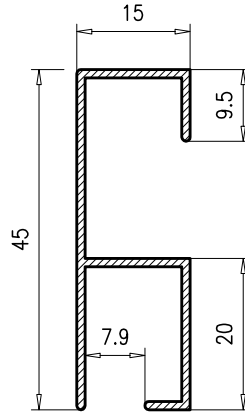

**2.429**  
 PESO TEORICO: 0.311  
 PERIMETRO: 0.21

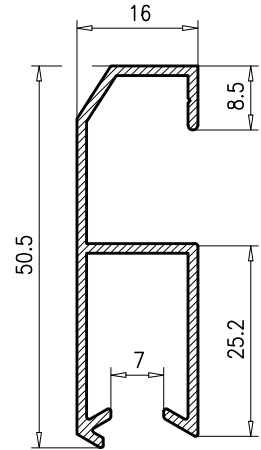

**3.798**  
 PESO TEORICO: 0.408  
 PERIMETRO: 0.23

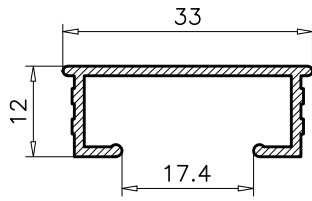

**2.423**  
 PESO TEORICO: 0.232  
 PERIMETRO: 0.13

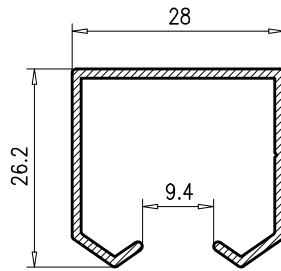

**3.153**  
 PESO TEORICO: 0.292  
 PERIMETRO: 0.18

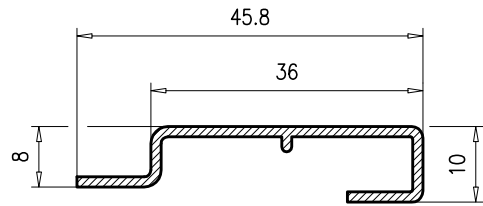

**1.227**  
 PESO TEORICO: 0.255  
 PERIMETRO: 0.14